

#48-1055 Riverwood Gate, Port Coquitlam, BC

Upper Floor: 604 SQ. FT.
 Main Floor: 606 SQ. FT.
 Lower Floor: 110 SQ. FT.
Total: 1320 SQ. FT.

Balcony: 115 SQ. FT.
 Garage: 481 SQ. FT.

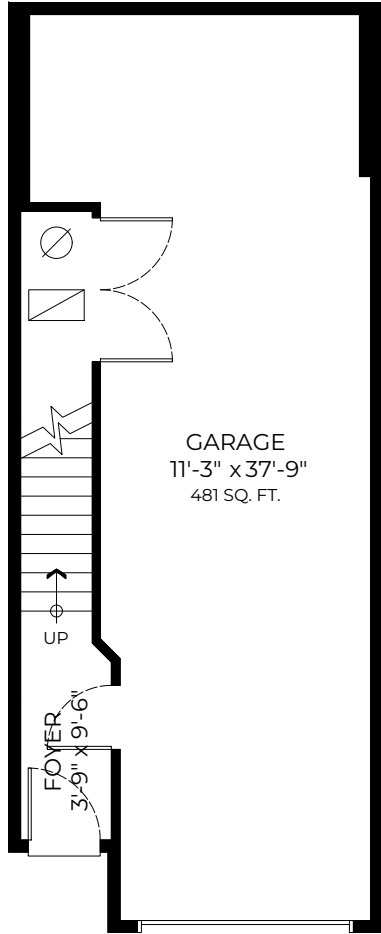

LOWER FLOOR PLAN
 Ceiling Height: 8'-0"

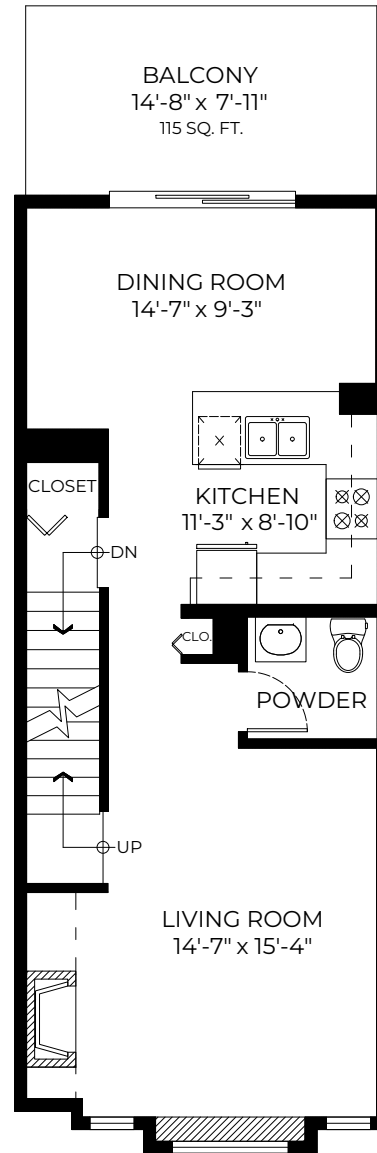

MAIN FLOOR PLAN
 Ceiling Height: 9'-0"

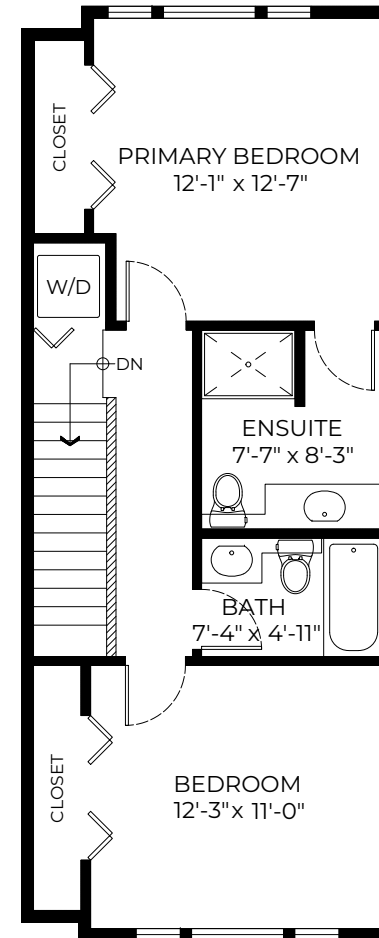

UPPER FLOOR PLAN
 Ceiling Height: 8'-0"

