

#106-2998 Robson Drive Coquitlam, BC

4 bedrooms + den + 3 1/2 bathrooms

Main Floor - 1,029 sq.ft.

Ceiling height - 8' 0" to 16' 10"



ENTRANCE



Floor plan measurements, dimensions, square footage, existing structures & features are approximations and for illustrative purposes only. E&O insured for \$1,000,000

#106-2998 Robson Drive Coquitlam, BC

4 bedrooms + den + 3 1/2 bathrooms

Lower Floor: 1,038 sq.ft.

Main Floor: 1,029 sq.ft.

Upper Floor: 1,134 sq.ft.

Total Interior: 3,201 sq.ft.

Attached Garage: 409 sq.ft.

Exterior Living: 339 sq.ft.

Upper Floor - 1,134 sq.ft.

Ceiling height - 8' 0"

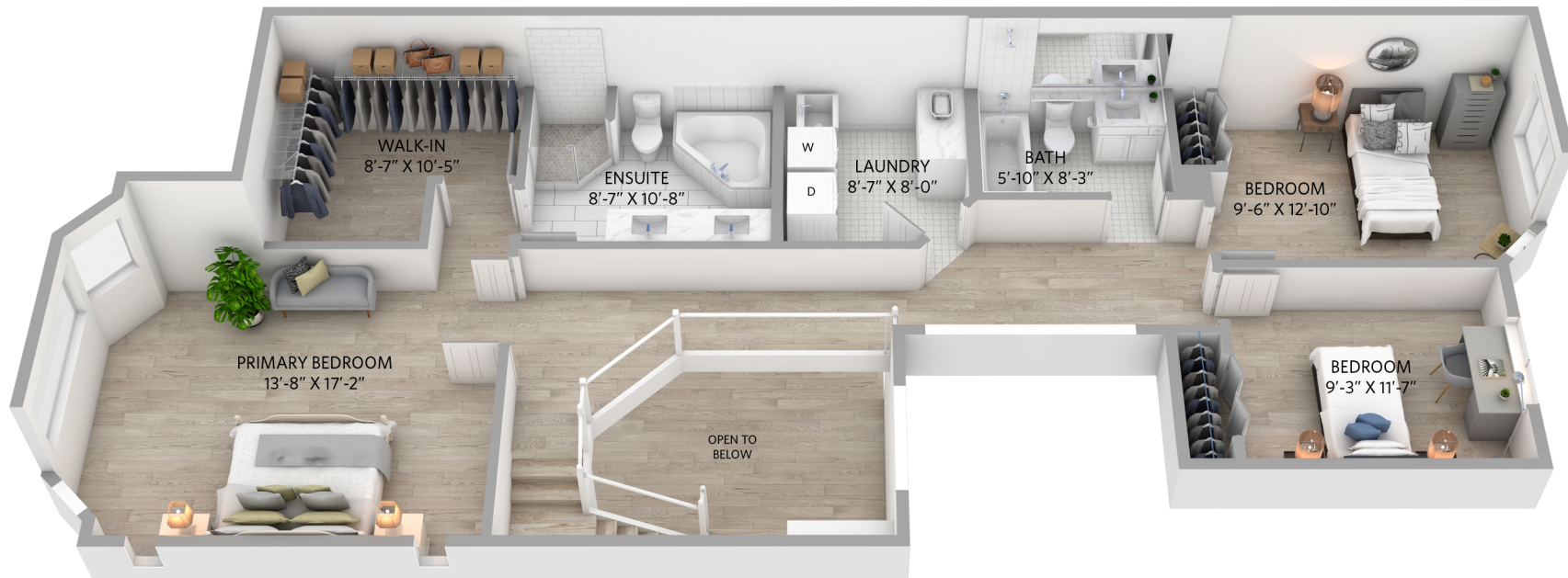

Floor plan measurements, dimensions, square footage, existing structures & features are approximations and for illustrative purposes only. E&O insured for \$1,000,000

#106-2998 Robson Drive Coquitlam, BC

4 bedrooms + den + 3 1/2 bathrooms

Lower Floor - 1,038 sq.ft.
Ceiling height - 7' 6" to 8' 2"



Floor plan measurements, dimensions, square footage, existing structures & features are approximations and for illustrative purposes only. E&O insured for \$1,000,000