

219-10584 153 STREET, SURREY, BC

MAIN FLOOR TOTAL: 1,605 SQ.FT.
PATIO: 256 SQ. FT.
STORAGE: 28 SQ.FT.

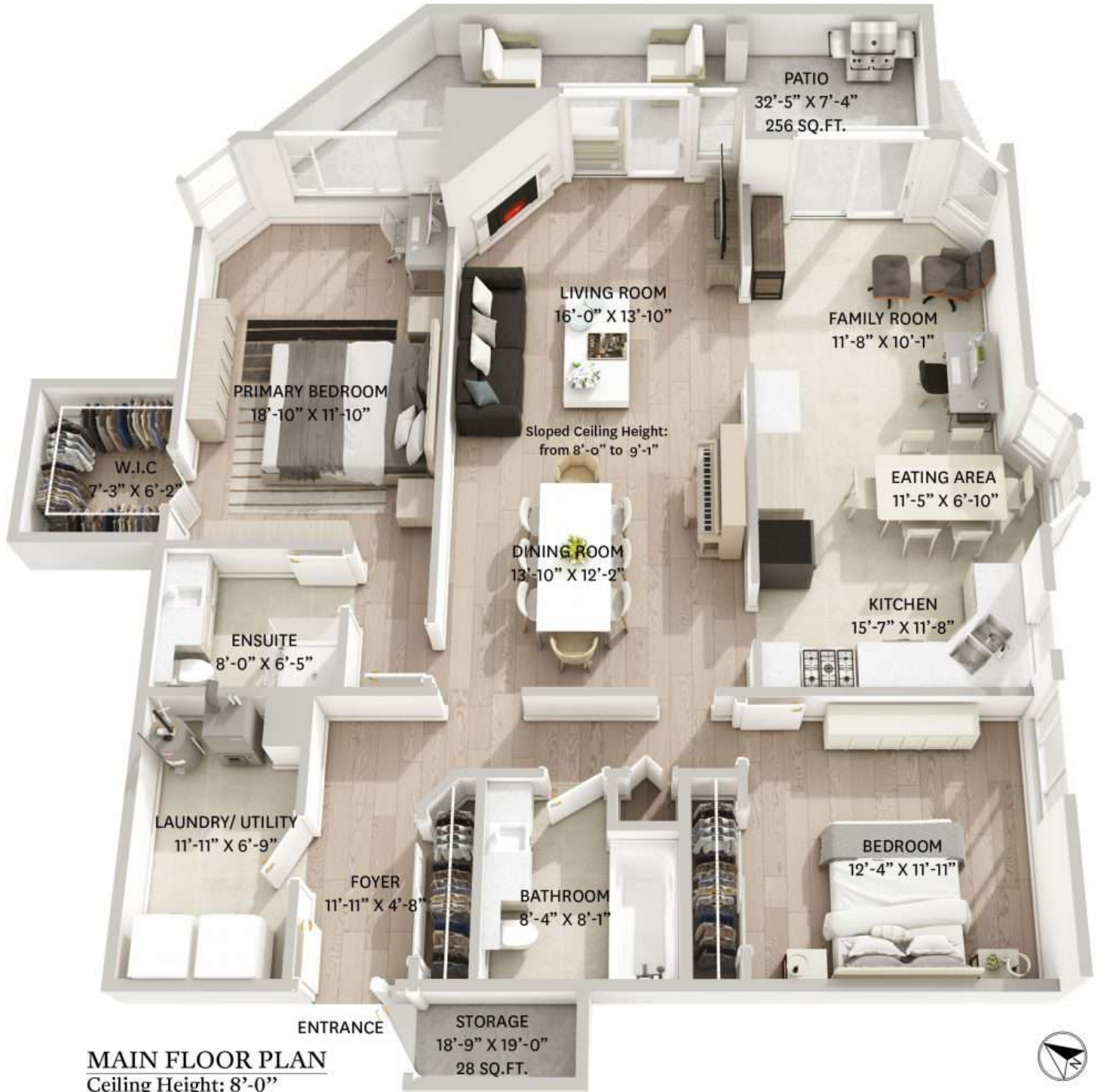

219-10584 153 STREET, SURREY, BC

MAIN FLOOR TOTAL: 1,605 SQ.FT.
PATIO: 256 SQ. FT.
STORAGE: 28 SQ.FT.



MAIN FLOOR PLAN
Ceiling Height: 8'-0"

