

LOWER FLOOR TOTAL: 1,042 SQ.FT. **GARAGE:** 605 SQ. FT.
MAIN FLOOR TOTAL: 1,092 SQ.FT. **PATIO:** 192 SQ. FT.
TOTAL: **2,134 SQ.FT.** **DECK:** 151 SQ. FT.
UNFINISHED TOTAL: 26 SQ.FT. **BALCONY:** 43 SQ. FT.
GRAND TOTAL: **2,160 SQ.FT.**

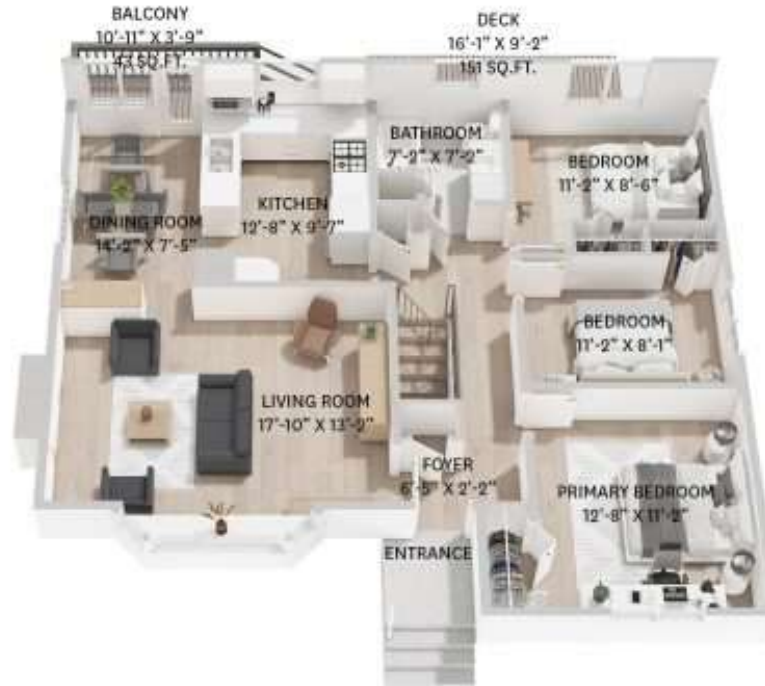

LOWER FLOOR PLAN
 Ceiling Height: 7'-9"



MAIN FLOOR PLAN
 Ceiling Height: 8'-0"



GARAGE
 Ceiling Height: 8'-4"

LOWER FLOOR TOTAL: 1,042 SQ.FT. **GARAGE:** 605 SQ. FT.
MAIN FLOOR TOTAL: 1,092 SQ.FT. **PATIO:** 192 SQ. FT.
TOTAL: **2,134 SQ.FT.** **DECK:** 151 SQ. FT.
UNFINISHED TOTAL: 26 SQ.FT. **BALCONY:** 43 SQ. FT.
GRAND TOTAL: **2,160 SQ.FT.**



LOWER FLOOR PLAN
 Ceiling Height: 7'-9"



MAIN FLOOR PLAN
 Ceiling Height: 8'-0"



GARAGE
 Ceiling Height: 8'-4"