

10 - 46858 RUSSELL ROAD, CHILLIWACK, BC

LOWER FLOOR TOTAL: 676 SQ.FT. GARAGE: 371 SQ. FT.
MAIN FLOOR TOTAL: 663 SQ.FT. BALCONY: 47SQ. FT.
UPPER FLOOR TOTAL: 849 SQ.FT. PATIO: 398SQ. FT.
TOTAL: 2,188 SQ.FT.



LOWER FLOOR PLAN
Ceiling Height: 8'-2"



MAIN FLOOR PLAN
Ceiling Height: 8'-0"

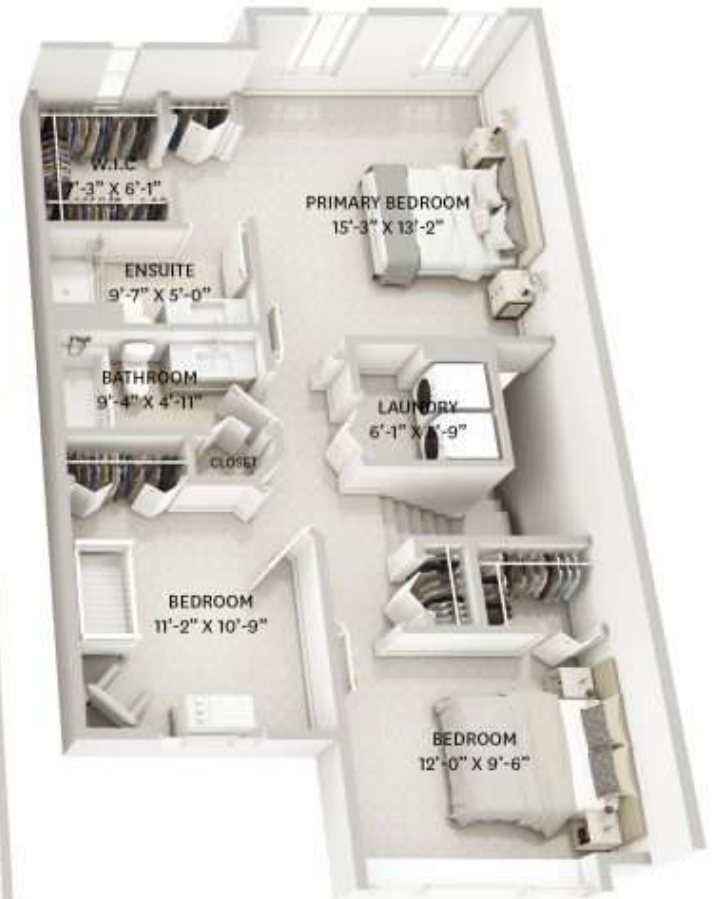

UPPER FLOOR PLAN
Ceiling Height: 8'-0"

