

12098 - 207A STREET, MAPLE RIDGE, BC

LOWER FLOOR TOTAL: 740 SQ. FT.
 MAIN FLOOR TOTAL: 1,335 SQ. FT.
 TOTAL: 2,075 SQ. FT.

PATIO: 408 SQ. FT.
 GARAGE: 337 SQ. FT.
 PORCH: 135 SQ. FT.
 DECK: 150 SQ. FT.

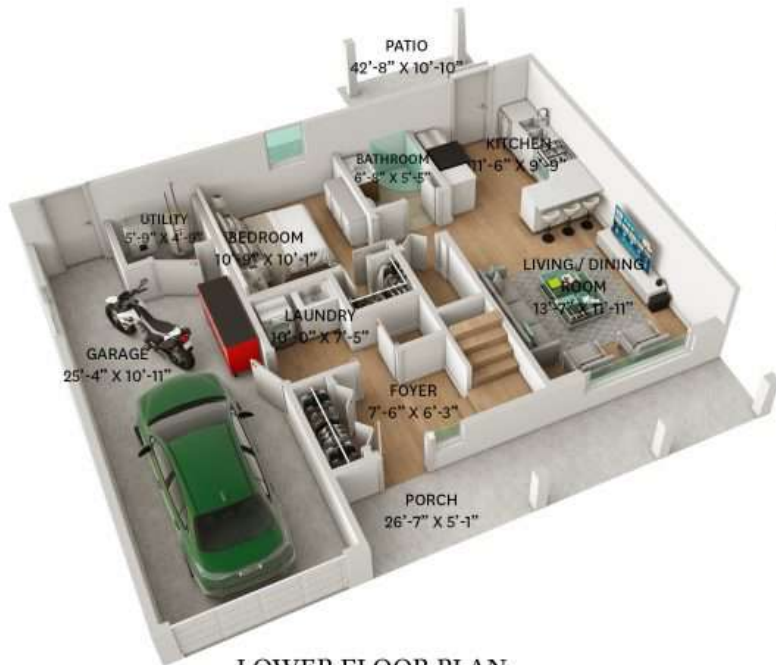

LOWER FLOOR PLAN
 Ceiling Height: 8'-0"



MAIN FLOOR PLAN
 Ceiling Height: 8'-0"



Dan Edwards
 778-889-6957
 Dano@themacnabs.com

floor plan designed by
 ishot.ca Enterprises Inc.
 604-368-7979
<http://ishot.ca>

THE FLOOR PLAN ILLUSTRATION IS NOT SUITABLE FOR CONSTRUCTION/ ARCHITECTURAL PURPOSES.
 MEASUREMENTS ARE APPROXIMATE AND MAY NOT BE TO SCALE. E&O INSURED.