

20756 RIVER ROAD, MAPLE RIDGE, BC

MAIN FLOOR TOTAL: 1,276 SQ. FT.
UPPER FLOOR TOTAL: 889 SQ. FT.
TOTAL: 2,165 SQ. FT.

STUDIO/REC. ROOM TOTAL: 743 SQ. FT.
DECK: 619 SQ. FT.
PATIO: 187 SQ. FT.
GARAGE: 415 SQ. FT.
BALCONY: 58 SQ. FT.

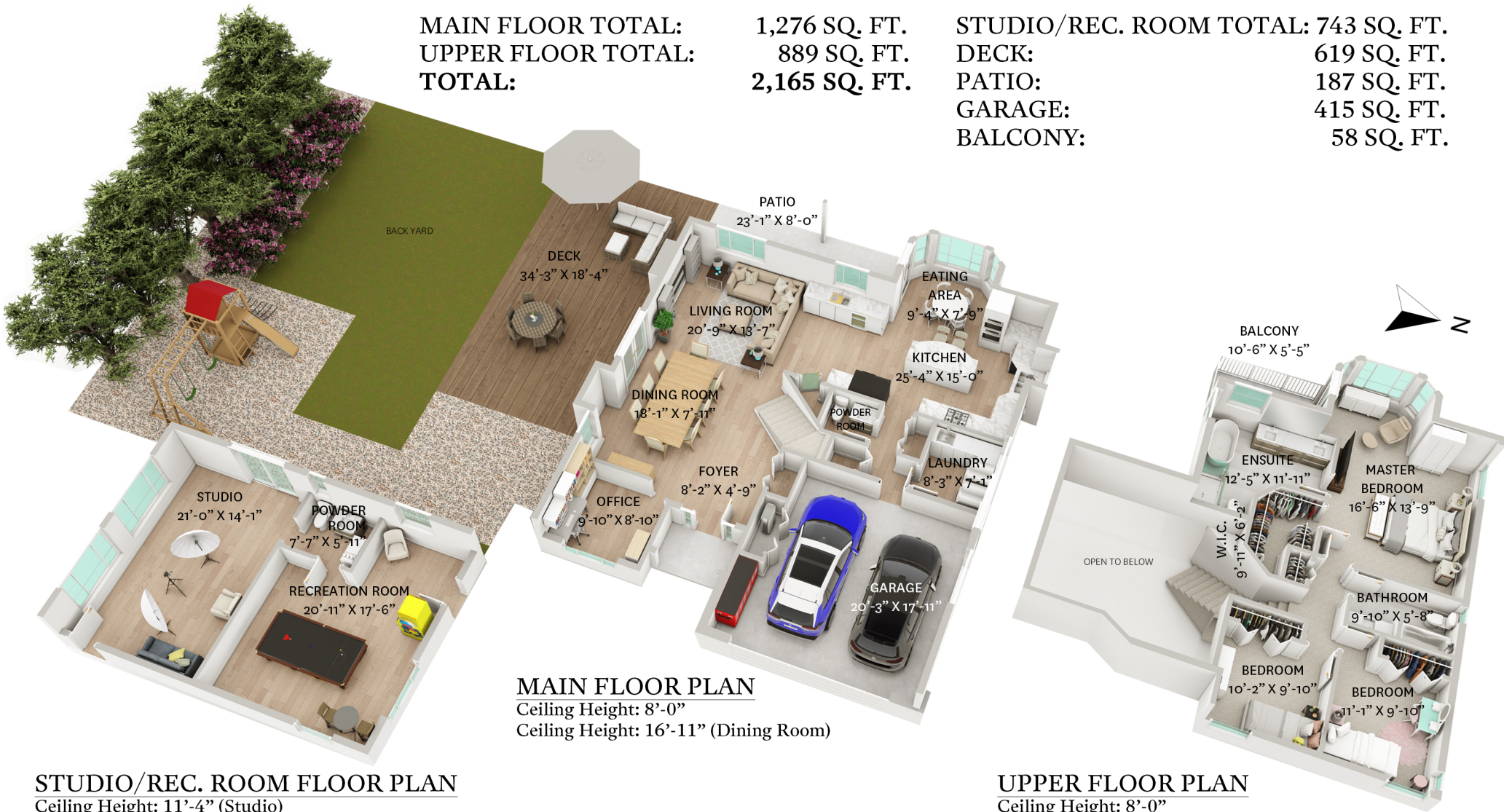

Jordan Macnab PREC*
 604-551-5695
 jordan@themacnabs.com

floor plan designed by
 ishot.ca Enterprises Inc.
 604-368-7979
 http://ishot.ca

*PERSONAL REAL ESTATE CORPORATION. THE FLOOR PLAN ILLUSTRATION IS NOT SUITABLE FOR CONSTRUCTION/ ARCHITECTURAL PURPOSES.
 MEASUREMENTS ARE APPROXIMATE AND MAY NOT BE TO SCALE. E&O INSURED.